

## 670003 and 670003-344 SPECIAL 1/2" DIAPHRAGM PUMPS

### GENERAL DESCRIPTION

The 670003-X special 1/2" diaphragm pumps are similar to models 66605J-XXX diaphragm pumps. These pumps feature a single piece inlet manifold and a single piece outlet manifold.

The 670003-X models and their standard model counterparts are shown in the chart at right. A 66605X-X Operator's Manual (PN 97999-99) is to be used for General Information, Installation, Operation and Maintenance. Follow the standard parts list with the exception of the items listed below.

### MODEL CHART

670003-X Model	Standard Model	Fluid Section Repair Kit	Air Section Repair Kit
670003	66605J-3EB	637140-EB	637141
670003-344	66605J-344	637140-44	637141

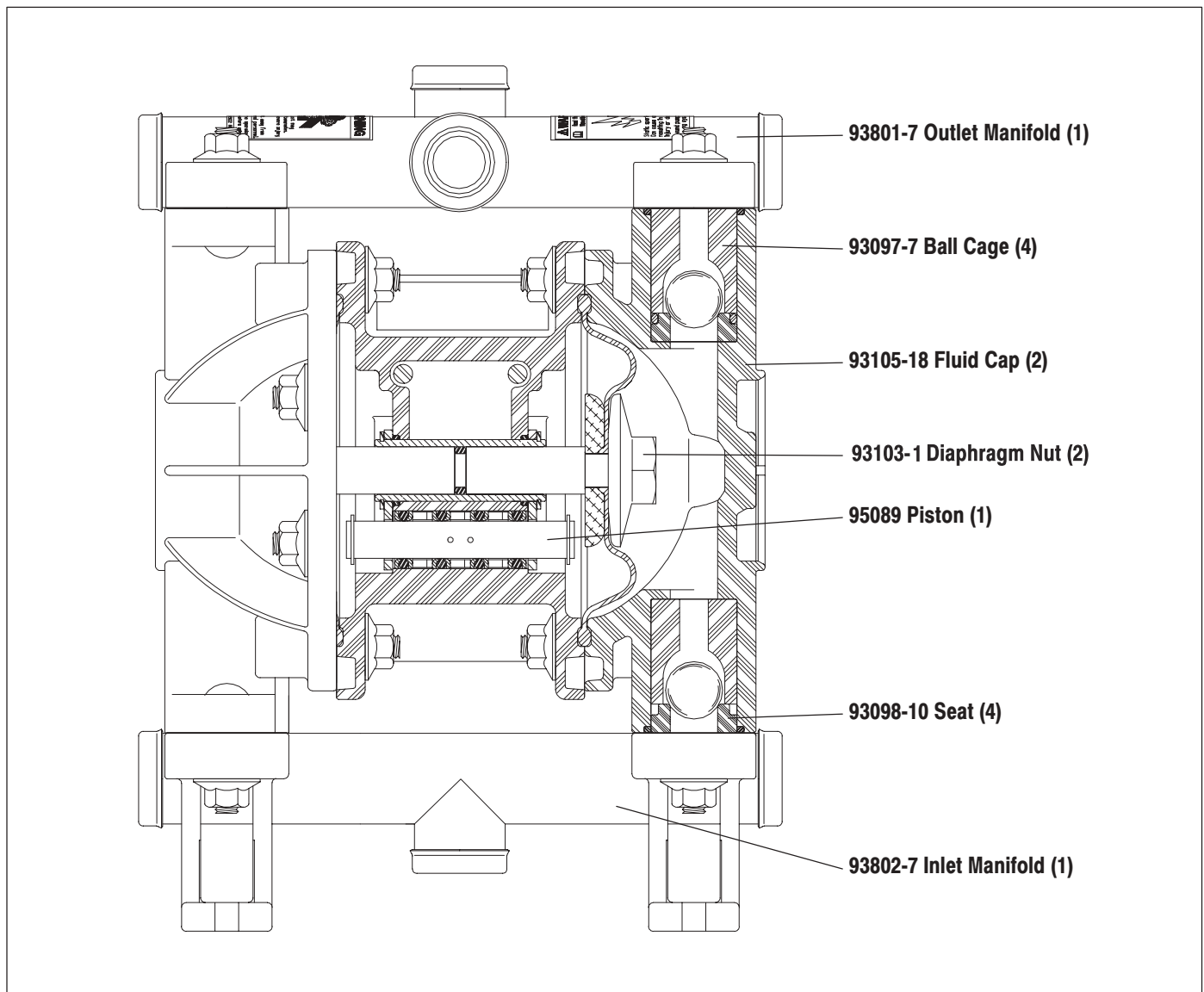

PN 97999-918

**INGERSOLL RAND COMPANY LTD**  
 209 NORTH MAIN STREET - BRYAN, OHIO 43506  
 (800) 495-0276 • FAX(800) 892-6276  
 www.ingersollrandproducts.com

© 2013 CCN 99886780

# ARO

**IR** Ingersoll Rand  
 Industrial Technologies